

8. Warning and Maintenance

- 8.1) During transportation, do not reverse, do not stress with heavy things, do not shock strongly.
- 8.2) Please use dry & soft cloth to clean the tray and side wall, in case dirt attached, only neutral cleanser can be used and please do not use nylon material which easily make the goods attached dirt to keep the shine surface.
- 8.3) When use any kind of chemical cleanser to banish the dirt and mustiness, please do follow the instructions specified on the user manual, container or bottle. After using cleanser, please do use clean water to wash the shower room, finally use dry & soft cloth to wipe the shower room.
- 8.4) In case some part leaky, check it carefully, perhaps some glass glue loose, if so, please use the new glass glue to refinish it. When inject water into the shower room, please keep the temperature of water not tower above 51 °C.
- 8.5) The following materials will bring bad to your health and the product, please do not use them to clean the shower room: acidic substance, alkalescence menstruum, hydrochloric acid, polish menstruum, nylon broom, sandpaper and something else easily harm your health and the products.
- 8.6) When use the cleanser, please do follow the instructions specified on the container of the cleanser, the wrong use may bring bad influences on your health as well as the shower room.

* In case there are some different between picture and produces, please take the products as standard or refer to the sample! We will assume no responsibility for difference, pls understand without further notice.

IG0105

OUR SHOWER ROOM'S

INSTALLATION GUIDE

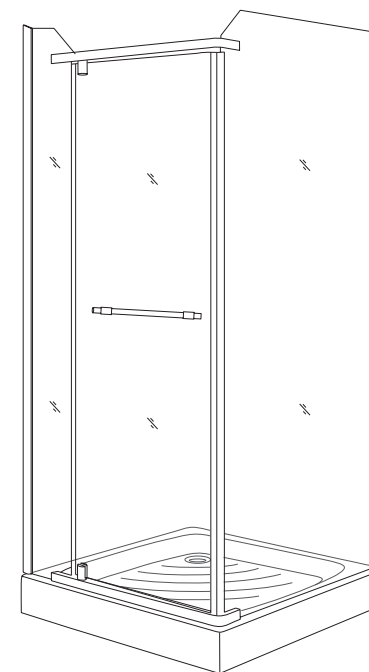

Thanks for choosing our products, we' ll provide best service for you. Please carefully read the whole manual before installation and use.

General Structures-----	Page. 2
Assemble The Legs, Pedestal, Drainer Pipe with the Tray	
Assemble Track and Profile-----	Page. 3
Assemble Doorframe Bracket-----	Page. 4
	Page. 5
Assemble wall profile -----	Page. 6
	Page. 7
Fix Hinge and open door glass -----	Page. 8
	Page. 9
Fix The Handle And The Waterproof-----	Page. 10
Warning and Maintenance-----	Page. 11

7. Fix the handle and the waterproof

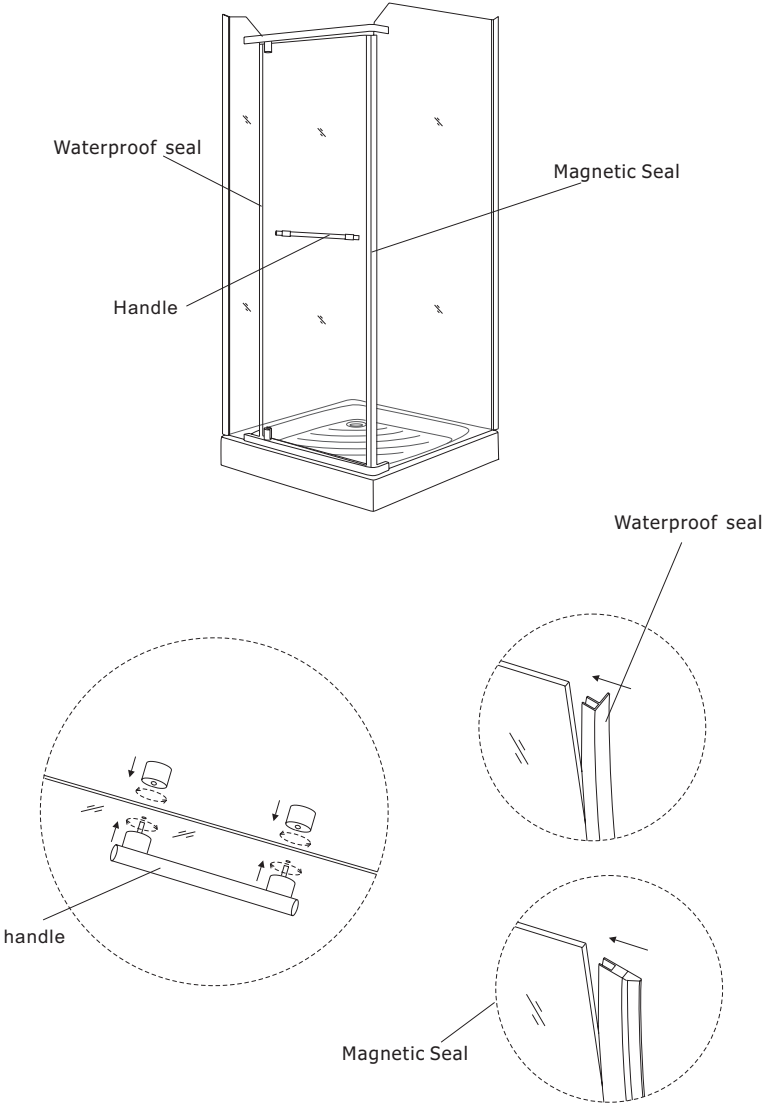

Assemble the door handles, waterproof seals and the magnetic seals with the glass door respectively. (as per the above drawings)

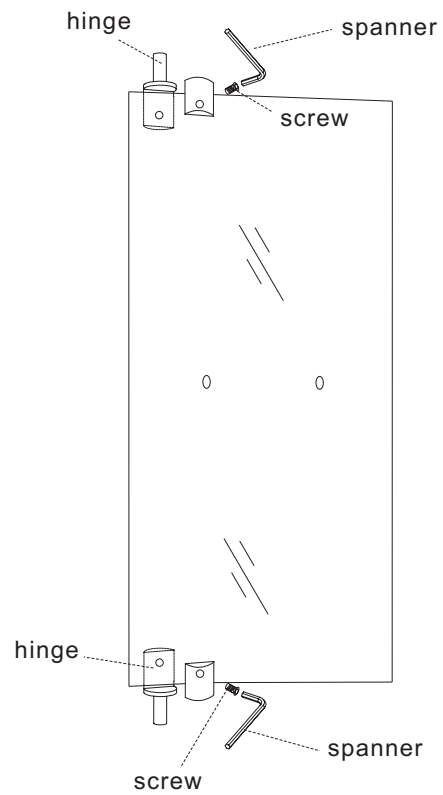

6.2) fix hinge into glass by spanner.

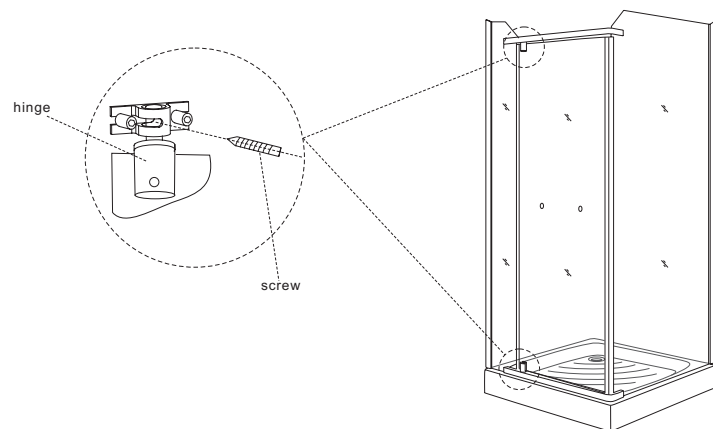

1) General Structures

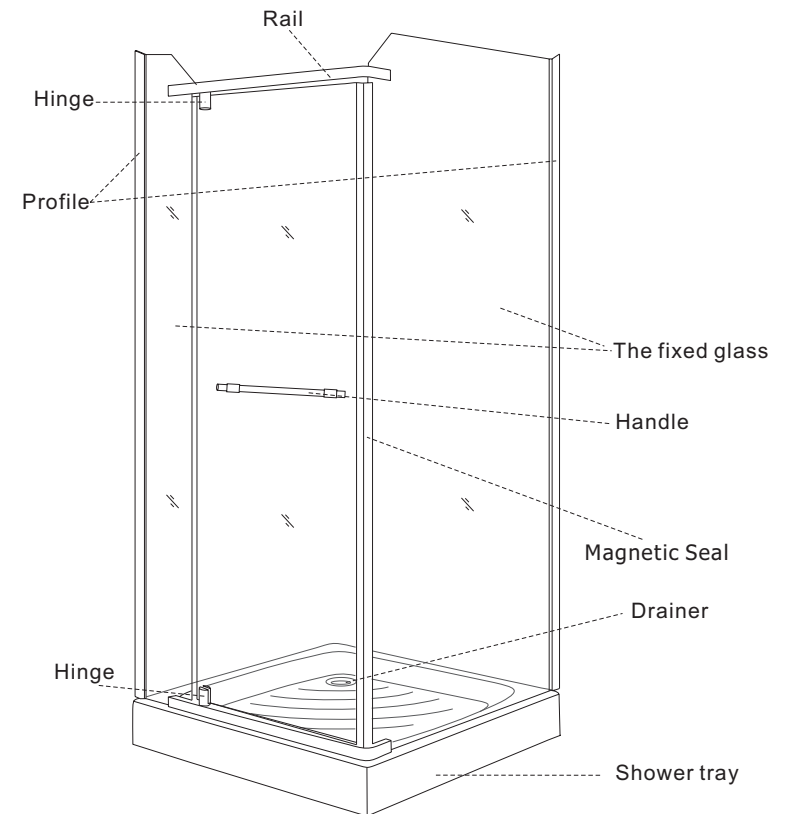

General View of The Shower Room

2) Main Proceeding for Installation

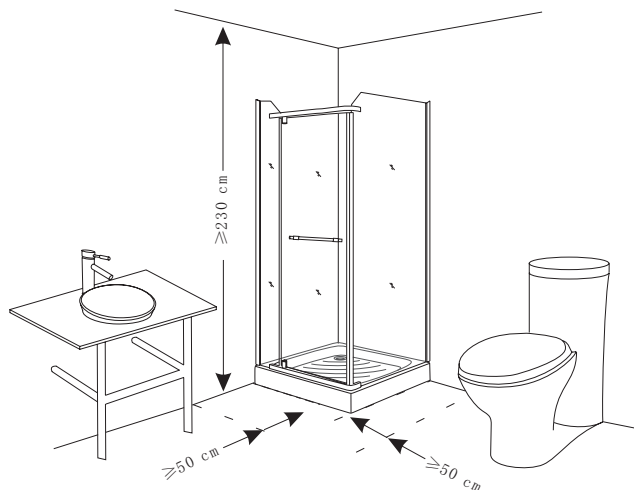

2.1) This shower room designed for corner position.

2.2) To ensure an easy & convenient installation or repair in future, There must be at least 50cm distance or free space between shower room and other bathroom furniture.

2.3) The height of inside house must be at least 230cm high.

3) Assemble The Legs, Pedestal, Drainer Pipe with the Tray

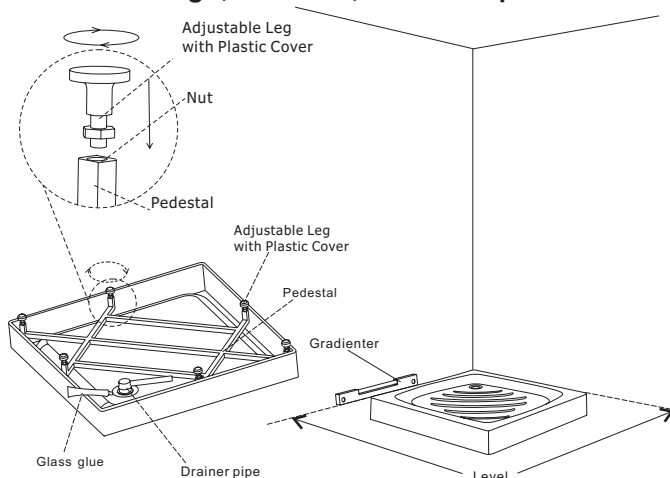

3.1) Check the drainer, if it is loose, please use glass glue to make it tight.

3.2) With the help of gradienter, adjust the adjustable legs to make the tray in level. If you need remove the front panel of shower tray, please take off the plastic cap on the screw in the front panel of tray, then take out the screw with screw driver.

6. Fix Hinge and open door glass

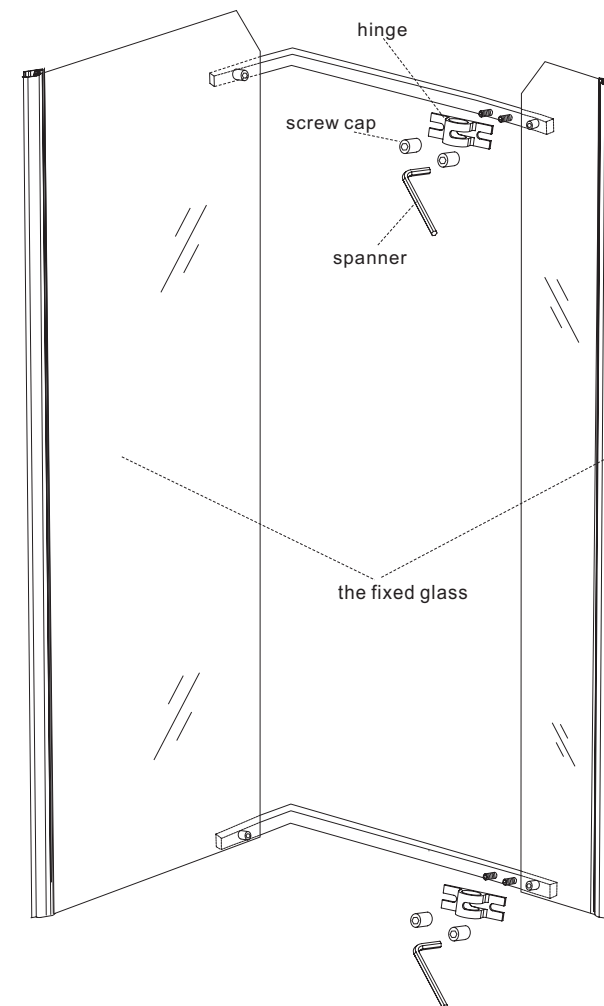

6.1) fix hinge into glass by spanner.

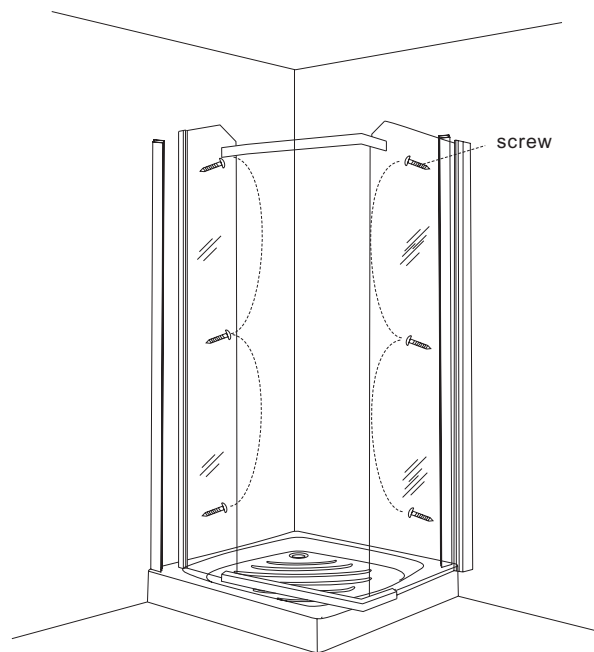

5.2) Put the bracket on the shower tray and use the screw fix the bracket in the side glass

4. Assemble Doorframe Bracket

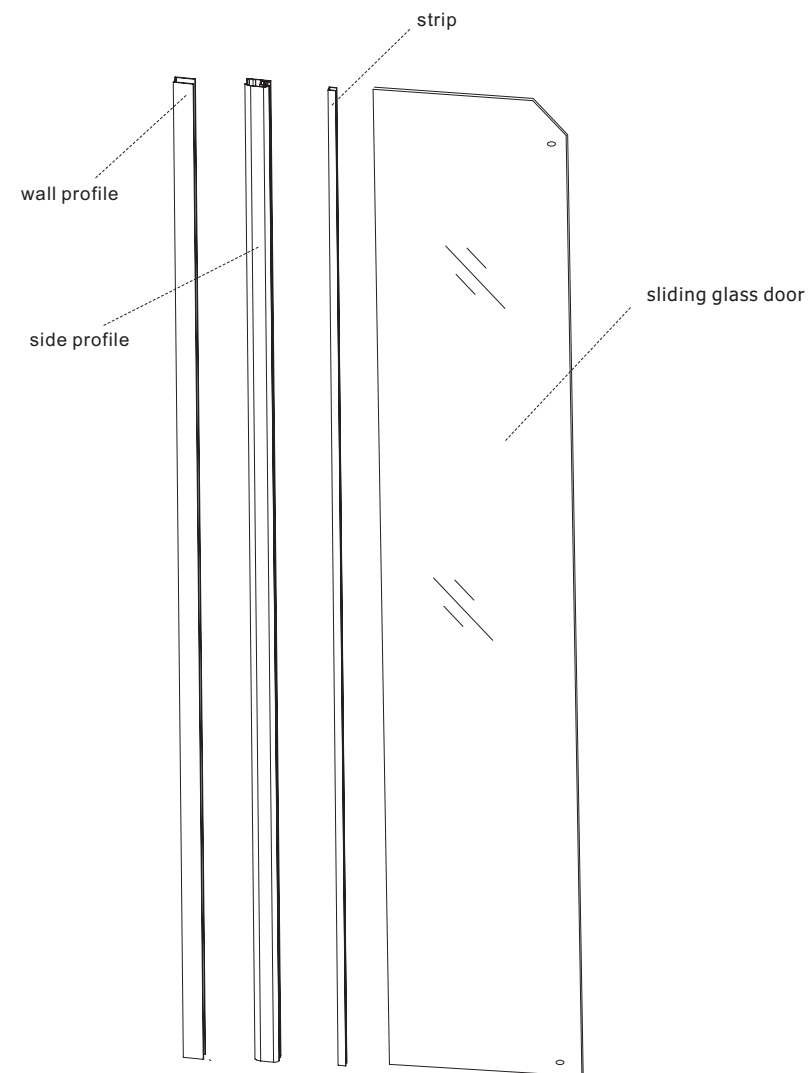

4.1) assemble wall profile ,side profile, strip, side glass together.

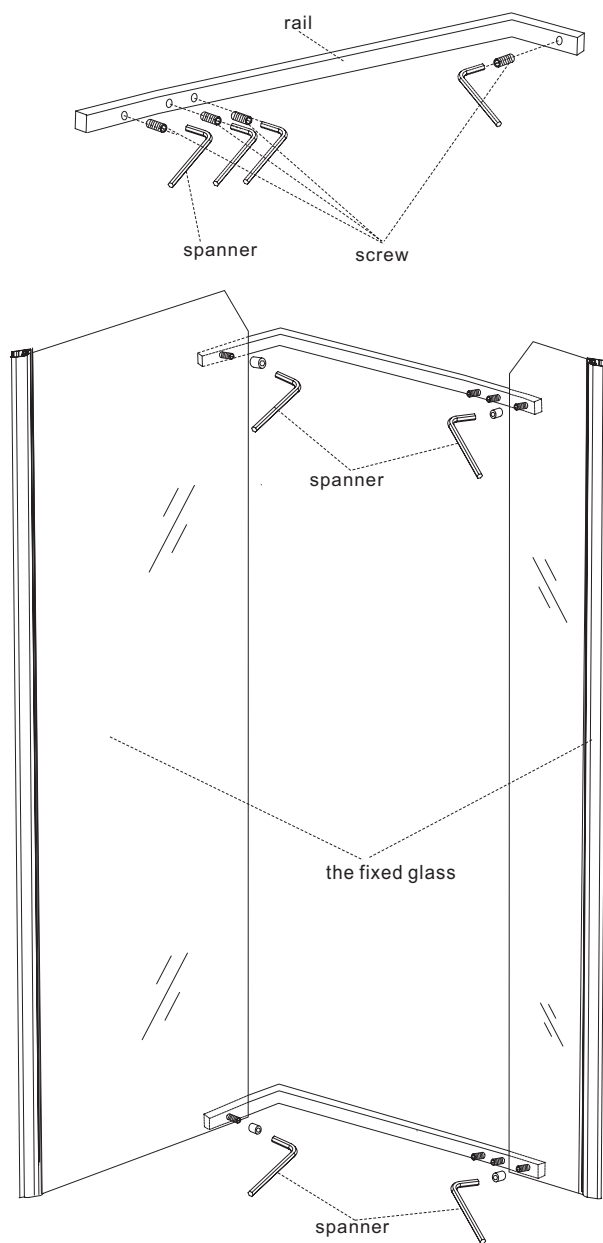

4.2) fix hinge into glass by spanner.

5. Assemble wall profile

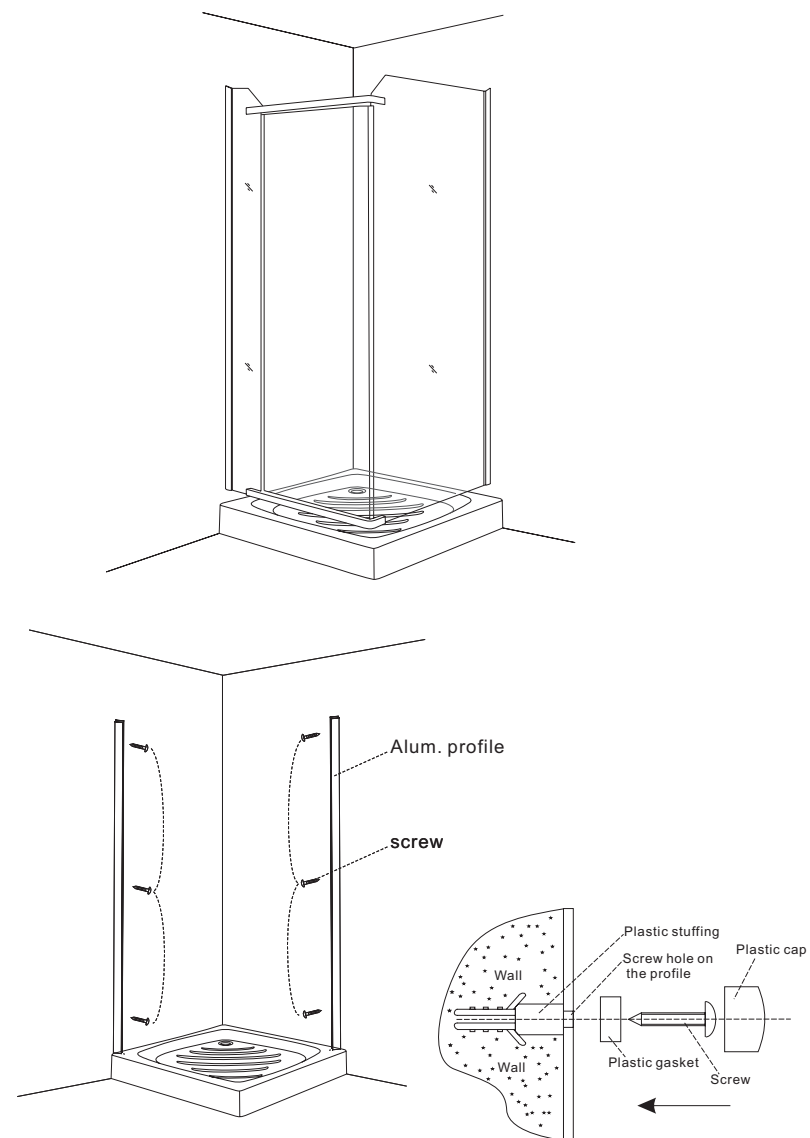

5.1) Put the frames on the shower tray, draw the frame place, then take out the sild profile and fixed it.